

TERMINATION OF FLASHING
WILL VARY

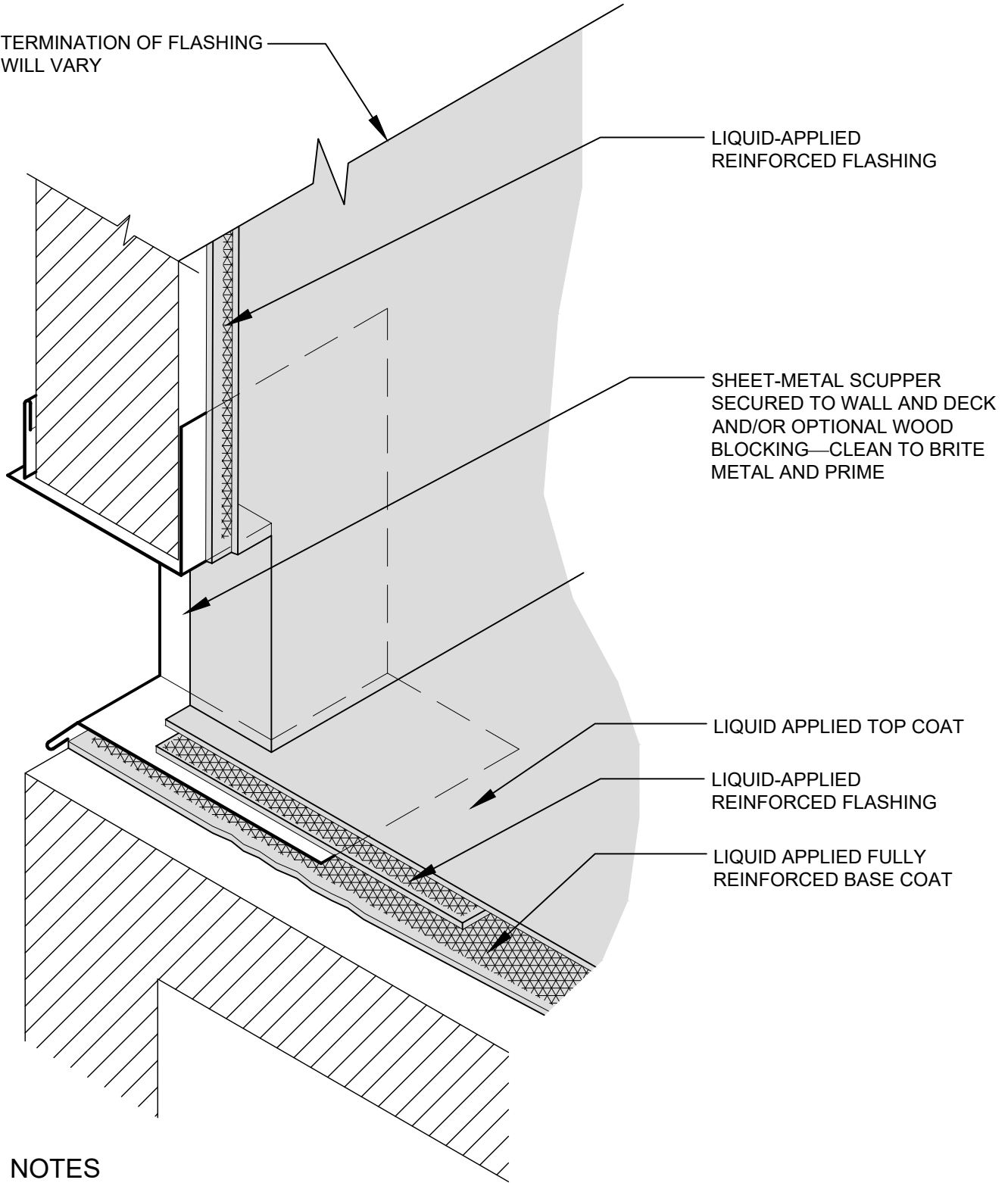

NOTES

1. THIS DETAIL DOES NOT ALLOW FOR DIFFERENTIAL MOVEMENT BETWEEN THE DECK AND WALL.
2. CONDUCTOR HEAD TO BE 1 INCH MINIMUM BELOW BOTTOM OF THROUGH-WALL SCUPPER.
3. PRIMING OF THE SUBSTRATE MAY BE REQUIRED. FOLLOW SPECIFICATIONS AND MANUFACTURER'S RECOMMENDATIONS.



SHEET TITLE:
BASE FLASHING AT
THROUGH-WALL SCUPPER FULLY
REINFORCED OVER CONCRETE

SCALE:
NTS

DRAWING No.:
DWG NO. LA-CFR-25