

EXISTING FLASHINGS
OVER AREA DIVIDER

8" MINIMUM
FLASHING HEIGHT

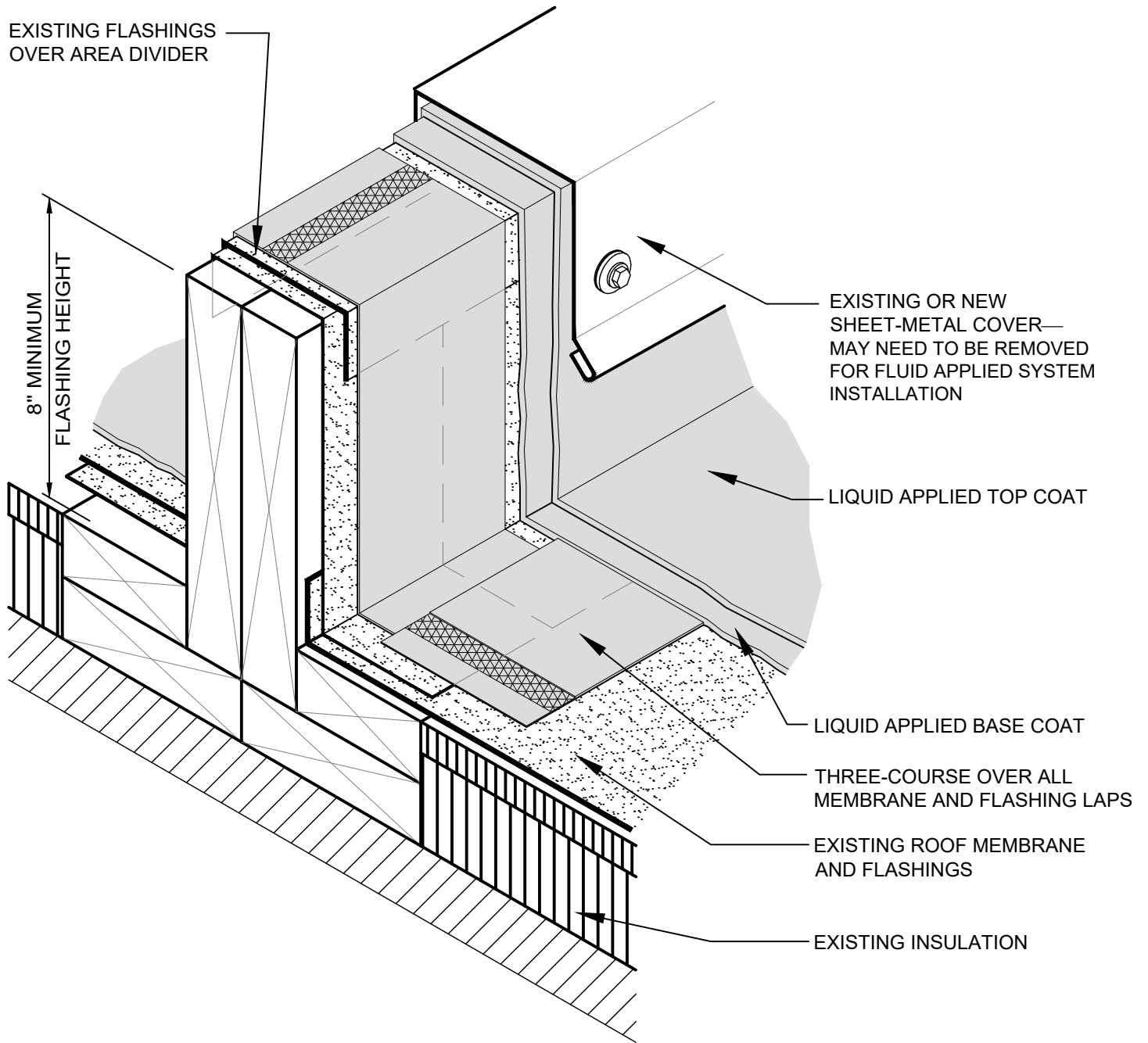

EXISTING OR NEW
SHEET-METAL COVER—
MAY NEED TO BE REMOVED
FOR FLUID APPLIED SYSTEM
INSTALLATION

LIQUID APPLIED TOP COAT

LIQUID APPLIED BASE COAT

THREE-COURSE OVER ALL
MEMBRANE AND FLASHING LAPS

EXISTING ROOF MEMBRANE
AND FLASHINGS

EXISTING INSULATION

NOTES

1. AN AREA DIVIDER SHOULD NEVER RESTRICT THE FLOW OF WATER.
2. FLASHING REQUIREMENTS ARE TYPICAL FOR BOTH SIDES OF THE AREA DIVIDER.
3. PRIMING OF THE SUBSTRATE MAY BE REQUIRED, FOLLOW SPECIFICATIONS AND MANUFACTURER RECOMMENDATIONS.