

EXISTING FLASHINGS
OVER AREA DIVIDER

8" MINIMUM
FLASHING HEIGHT

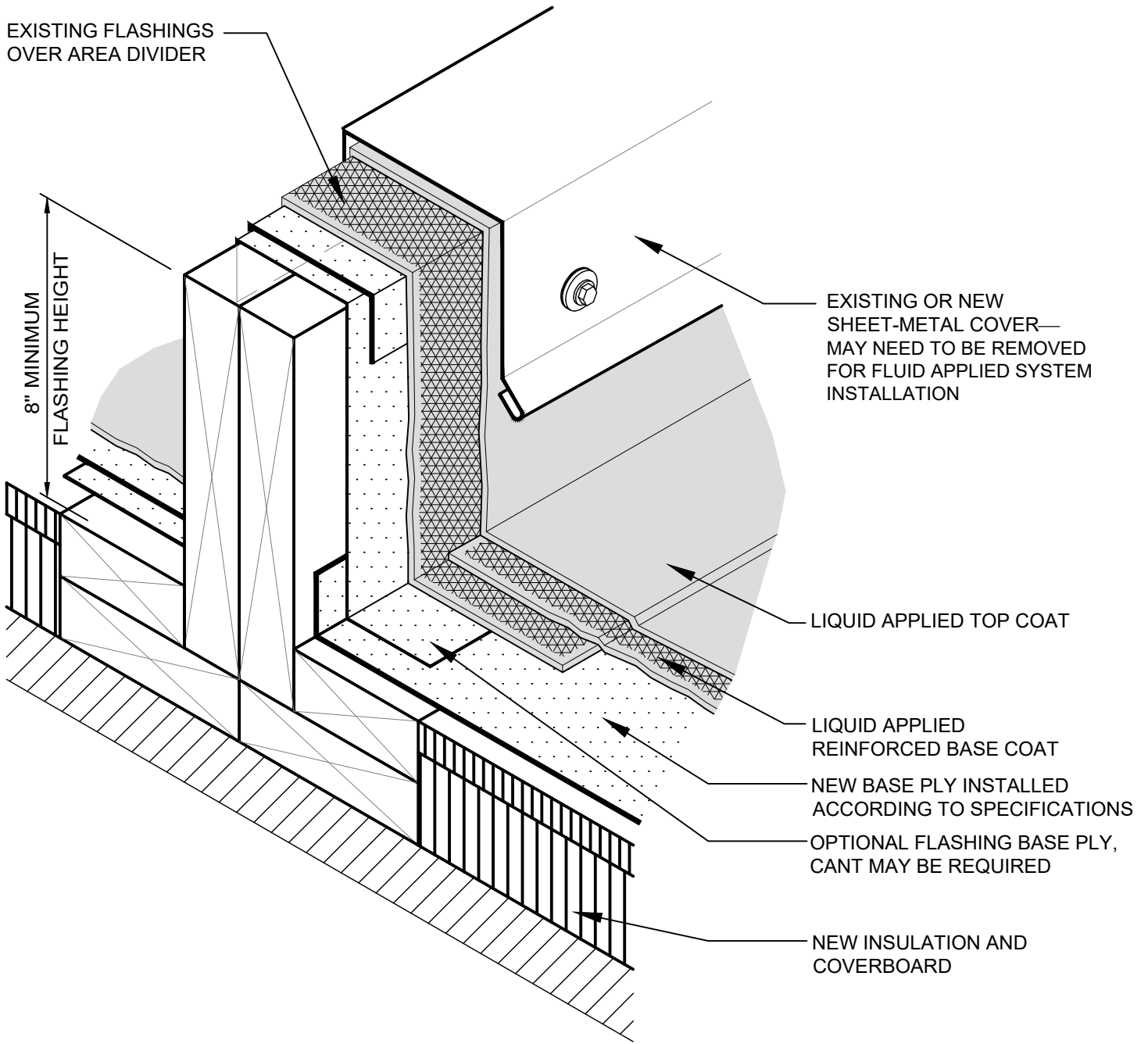

EXISTING OR NEW
SHEET-METAL COVER—
MAY NEED TO BE REMOVED
FOR FLUID APPLIED SYSTEM
INSTALLATION

LIQUID APPLIED TOP COAT

LIQUID APPLIED
REINFORCED BASE COAT

NEW BASE PLY INSTALLED
ACCORDING TO SPECIFICATIONS

OPTIONAL FLASHING BASE PLY,
CANT MAY BE REQUIRED

NEW INSULATION AND
COVERBOARD

NOTES

- 1. AN AREA DIVIDER SHOULD NEVER RESTRICT THE FLOW OF WATER.
- 2. FLASHING REQUIREMENTS ARE TYPICAL FOR BOTH SIDES OF THE AREA DIVIDER.
- 3. PRIMING OF THE SUBSTRATE MAY BE REQUIRED, FOLLOW SPECIFICATIONS AND MANUFACTURER RECOMMENDATIONS.
- 4. REINFORCEMENT MUST BE FULLY SATURATED OR ENCAPSULATED IN BASE COAT AS DESCRIBED IN SPECIFICATIONS.



SHEET TITLE:
**BASE FLASHING AT AREA
DIVIDER IN ROOF SYSTEM LIQUID
APPLIED PLUS SYSTEM**

SCALE:
NTS
DRAWING No.:
DWG NO. LA-PR-09