

NEW BASE PLY STRIPPING  
SET IN SPECIFIED SEALANT  
OR ADHESIVE

CLEAN TO BRIGHT  
METAL AND PRIME

LIQUID APPLIED TOP COAT

LIQUID APPLIED  
REINFORCED  
BASE COAT

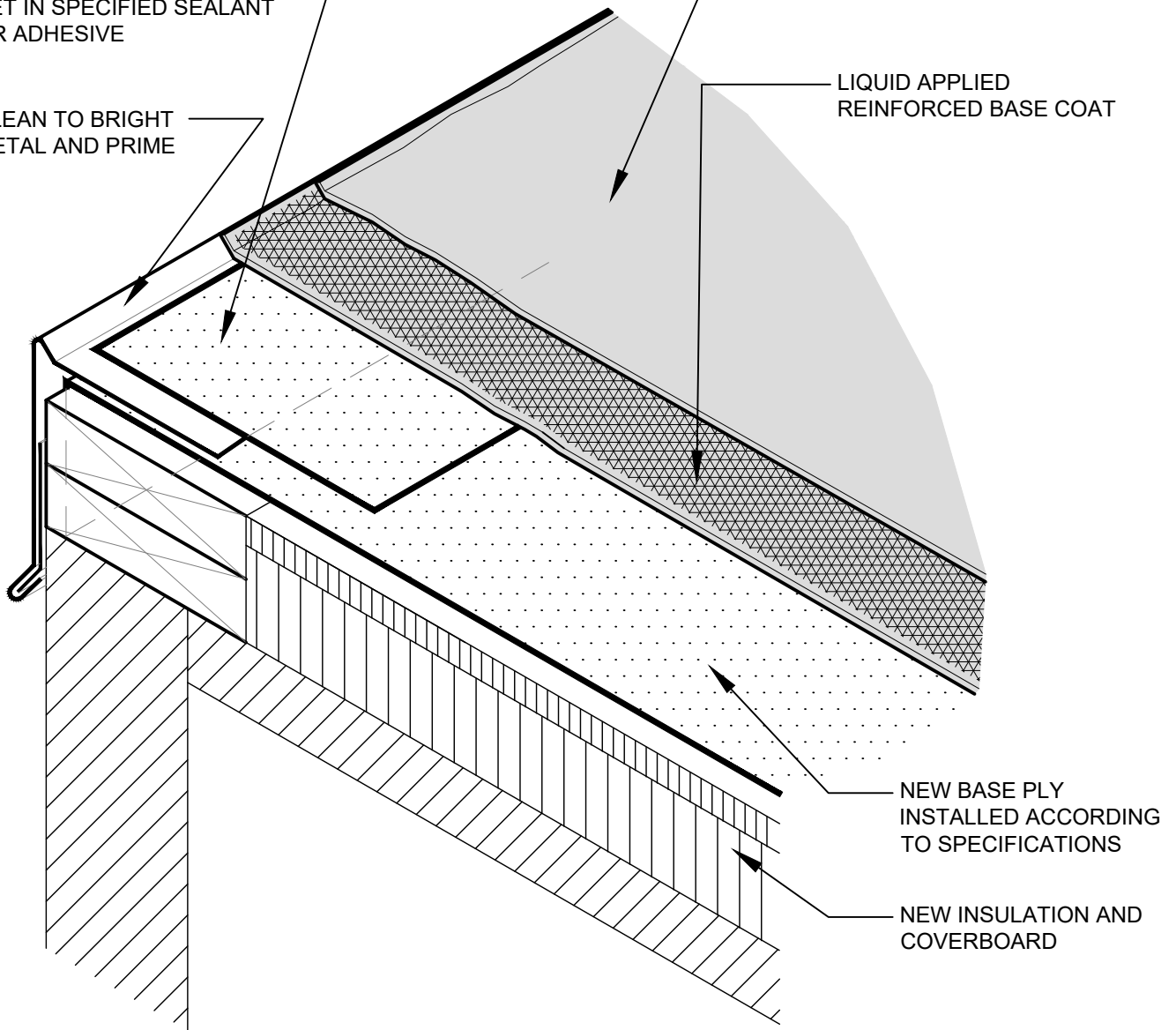

NEW BASE PLY  
INSTALLED ACCORDING  
TO SPECIFICATIONS

NEW INSULATION AND  
COVERBOARD

## NOTES

1. PRIMING OF THE SUBSTRATE MAY BE REQUIRED, FOLLOW SPECIFICATIONS AND MANUFACTURER RECOMMENDATIONS.
2. REINFORCEMENT MUST BE FULLY SATURATED OR ENCAPSULATED IN BASE COAT AS DESCRIBED IN SPECIFICATIONS.



SHEET TITLE:  
EMBEDDED EDGE METAL FLASHING  
[GRAVEL STOP] LIQUID APPLIED  
PLUS SYSTEM

SCALE:  
NTS

DWG NO. LA-PR-03