

NON-LIFTABLE

APPROVED SEALANT  
BEHIND TOP OF FLASHING

MECHANICAL UNIT

METAL COUNTERFLASHING, FASTEN W/  
EPDM WASHERED FASTENERS (12" O.C.)

TREMPY KEE FLASHING (FULLY ADHERED)

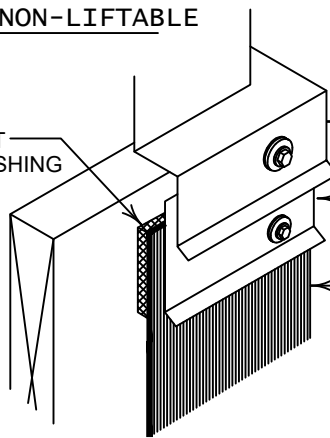

8" MIN.

GALVANIZED ANNULAR  
RING SHANK NAILS  
(3" O.C.)

ROOF TOP UNIT  
OR SKYLIGHT

EPDM WASHERED FASTENER  
AS REQUIRED

TREMPY KEE MEMBRANE FLASHING  
ADHERED IN TREMPY KEE LV BONDING  
ADHESIVE

PREMOLDED CORNER

HOT AIR WELD

WOOD CURB CONSTRUCTION

INSULATION ATTACHED PER  
SPECIFICATION REQUIREMENTS

TREMPY KEE  
MEMBRANE

APPROVED ALUMINUM TERMINATION/  
RESTRAINT BAR FASTENED  
WITH APPROVED FASTENERS  
(8" O.C.)

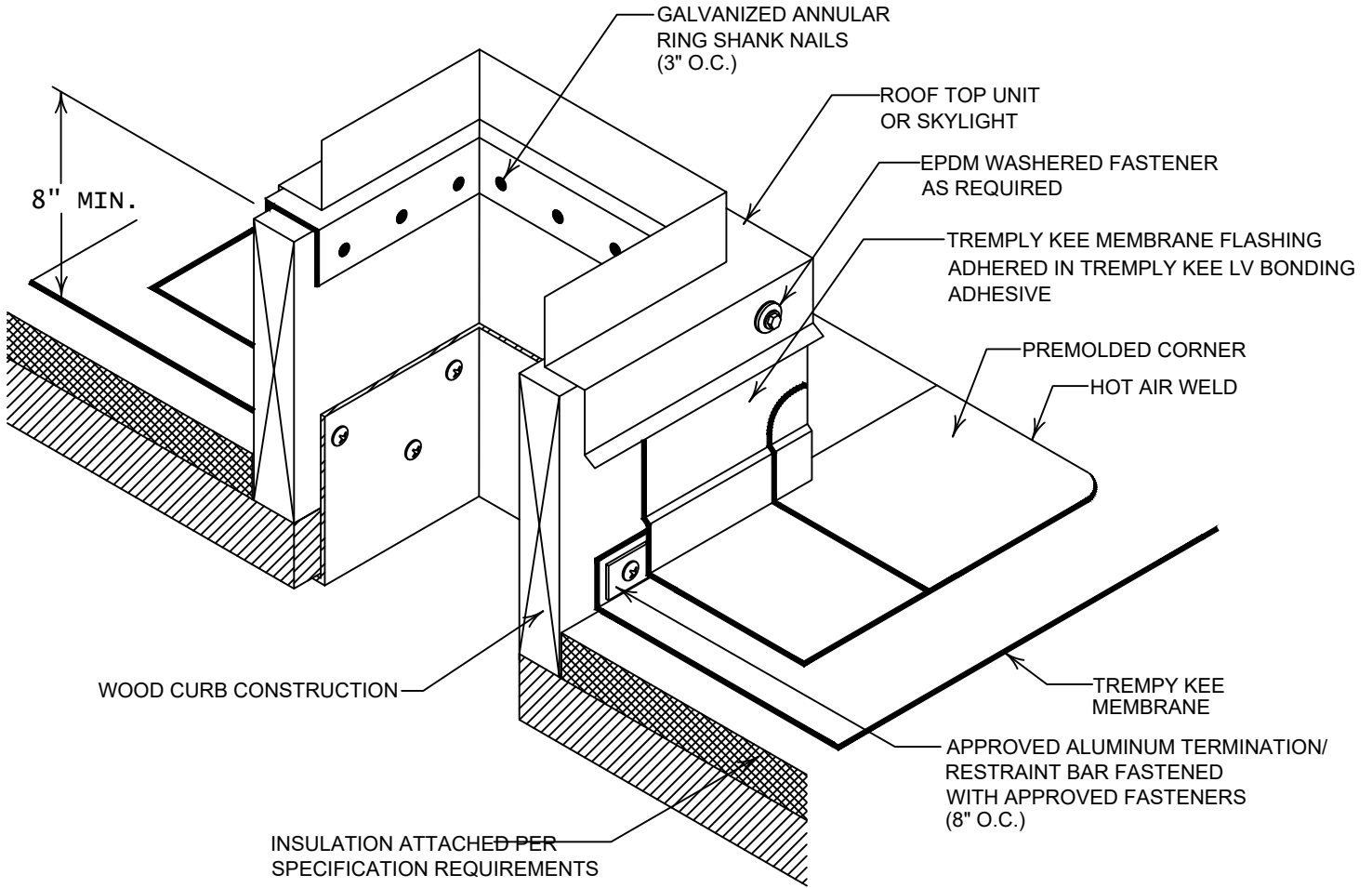

SHEET TITLE:  
TYPICAL WOOD OR SKYLIGHT CURB  
FLASHING (BLOCKING ALTERNATE)  
T-BAR RESTRAINT

SCALE:  
NTS

DRAWING No.:  
DWG NO. 124