

**NOTES**

1. DETAIL TO BE USED IN CONJUNCTION WITH STANDARD GUIDE SPECIFICATION CONTAINING REQUIREMENTS FOR NAILERS, INSULATION ETC.
2. FOR INSULATION THICKNESS GREATER THAN 8" (203 mm), A HARD BOARD IS REQUIRED ON MECHANICALLY FASTENED SYSTEMS ONLY.
3. APPLY TPO CUT EDGE SEALANT TO ALL CUT REINFORCED TPO EDGES.

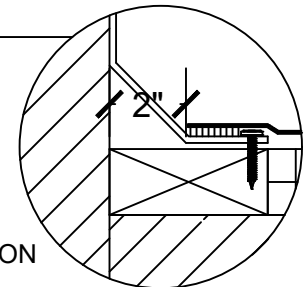

SHEET TITLE:

COATED METAL WALL  
FLASHING JOINT DETAIL

SCALE:

NTS

DRAWING No.:

DWG NO. 09