

PLAN VIEW

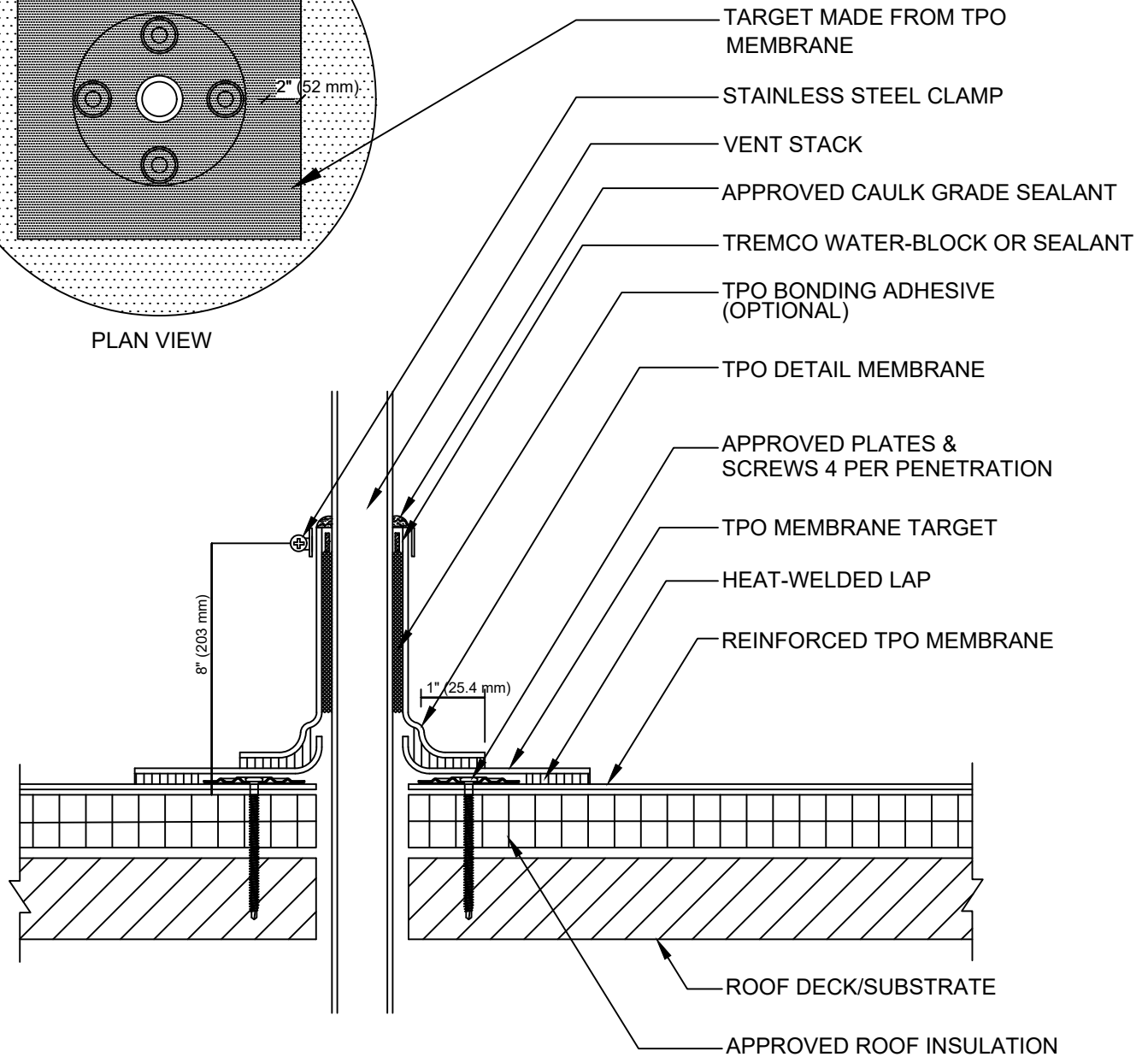

- TARGET MADE FROM TPO MEMBRANE
- STAINLESS STEEL CLAMP
- VENT STACK
- APPROVED CAULK GRADE SEALANT
- TREMCO WATER-BLOCK OR SEALANT
- TPO BONDING ADHESIVE (OPTIONAL)
- TPO DETAIL MEMBRANE
- APPROVED PLATES & SCREWS 4 PER PENETRATION
- TPO MEMBRANE TARGET
- HEAT-WELDED LAP
- REINFORCED TPO MEMBRANE
- ROOF DECK/SUBSTRATE
- APPROVED ROOF INSULATION

NOTES

1. FOR INSULATION THICKNESS GREATER THAN 8" (203 mm), A HARD BOARD IS REQUIRED ON MECHANICAL SYSTEMS ONLY.
2. APPLY HEAT TO UNREINFORCED DETAIL MEMBRANE AND FORM BY HAND PRIOR TO HOT AIR WELDING.
3. APPLY TPO CUT EDGE SEALANT TO ALL CUT REINFORCED TPO EDGES.



SHEET TITLE:

FIELD WRAPPED PENETRATION
FLASHING DETAIL

SCALE:

NTS

DRAWING No.:

DWG NO. 41