

FLASHING KEY

- OVER 24" (610 mm) REQUIRES BONDING ADHESIVE
- UP TO 24" (610 mm) DRY HUNG

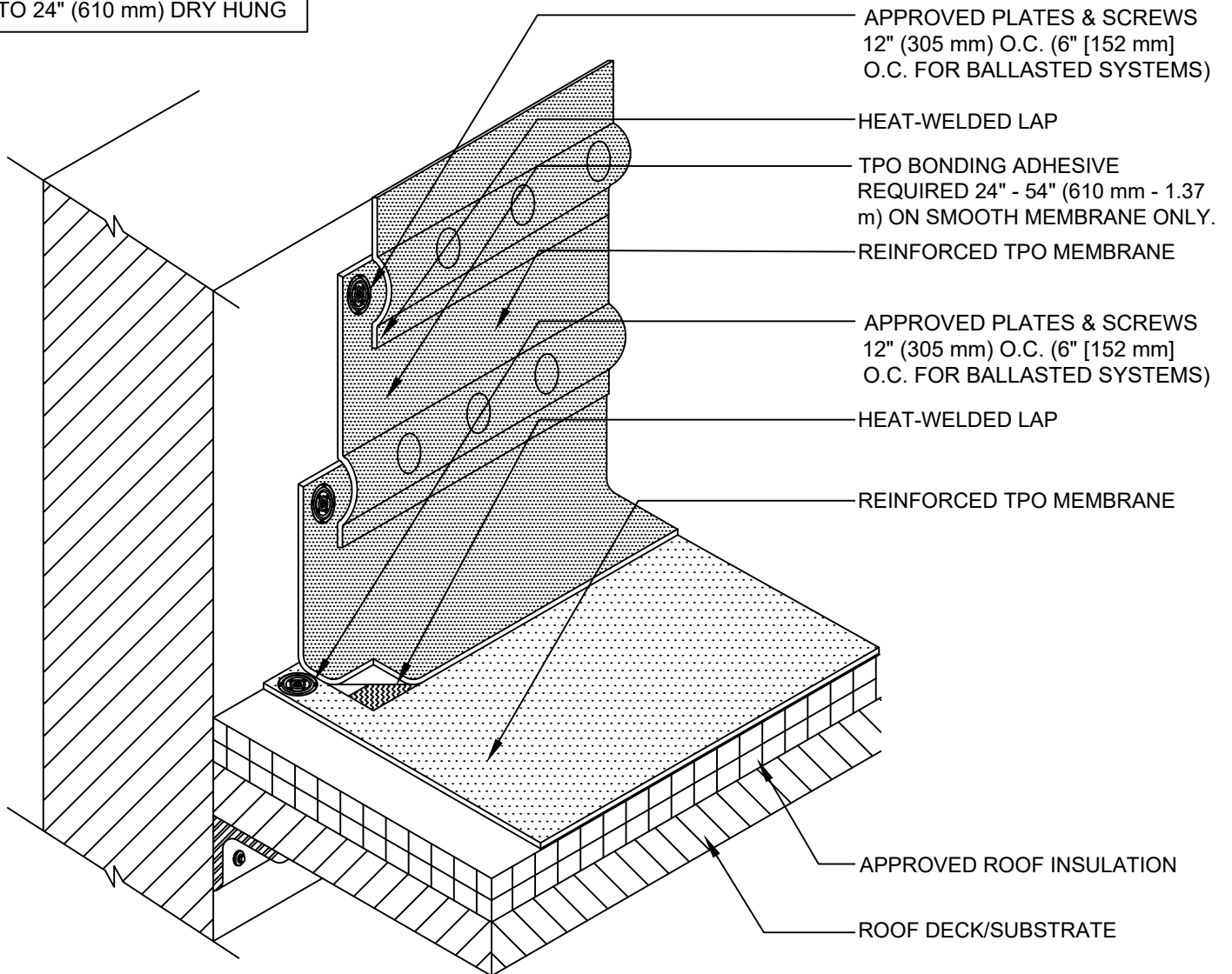

NOTES

1. FOR INSULATION THICKNESS GREATER THAN 8" (203 mm), A HARD BOARD IS REQUIRED ON MECHANICALLY FASTENED SYSTEMS ONLY.
2. 24" (610 mm) MAX. DIMENSION FOR LOOSE-APPLIED FLASHINGS.
3. 54" (1.37 m) MAX. DIMENSION FOR FULLY ADHERED FLASHINGS.
4. APPLY TPO CUT EDGE SEALANT TO ALL CUT REINFORCED TPO EDGES.



SHEET TITLE:

HIGH WALL FLASHING DETAIL
WITH PLATES AND FASTENERS

SCALE:

NTS

DRAWING No.:

DWG NO. 46