

MAXIMUM ROOF
SLOPE 3:12

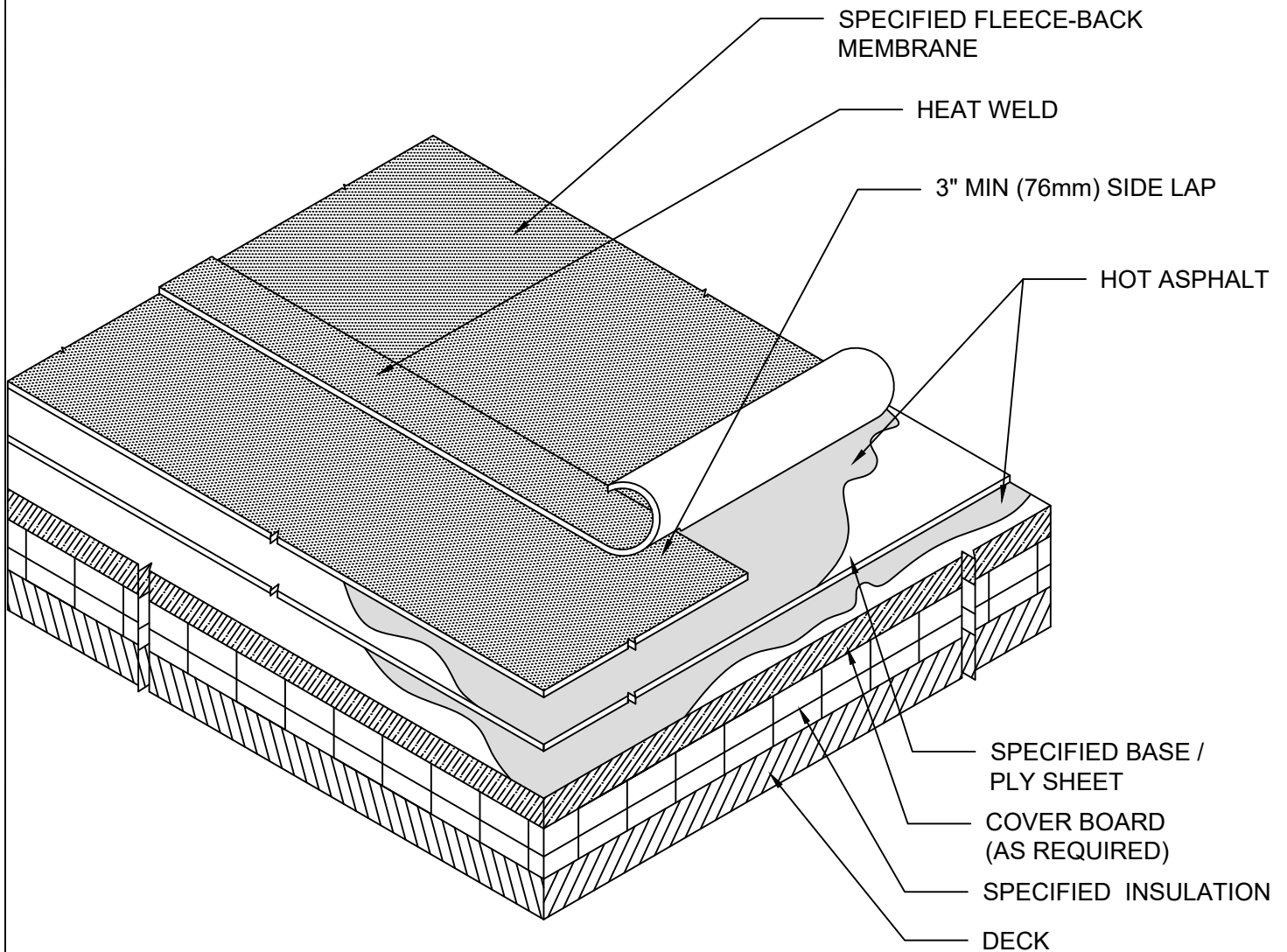

NOTES

1. FOR SLOPES LESS THAN 1/2:12, TYPE III OR IV ASPHALT CAN BE USED. TYPE IV MUST BE USED ON ALL SLOPES 1/2:12 AND OVER.
2. **ASPHALT SHALL BE APPLIED AT ITS EVT TEMPERATURE TO OBTAIN A PROPER BOND, TYPICALLY WITHIN THE RANGE OF 425°F (218°C) TO 475°F (246°C), IN A UNIFORM LAYER, WITHOUT VOIDS, AT A RATE OF 25 LB (11.3kg) PER SQUARE (9.2sq. m) ±20%**
3. RUN SHEETS PERPENDICULAR WITH GUTTER



SHEET TITLE:

HYBRID SYSTEM DETAIL

SCALE:

NTS

DRAWING No.:

DWG NO. 48