

ALTERNATE INSTALLATION

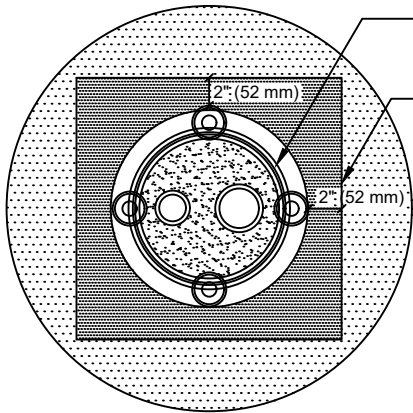

TPO PREFORMED VENT BOOT

TARGET MADE FROM TPO MEMBRANE

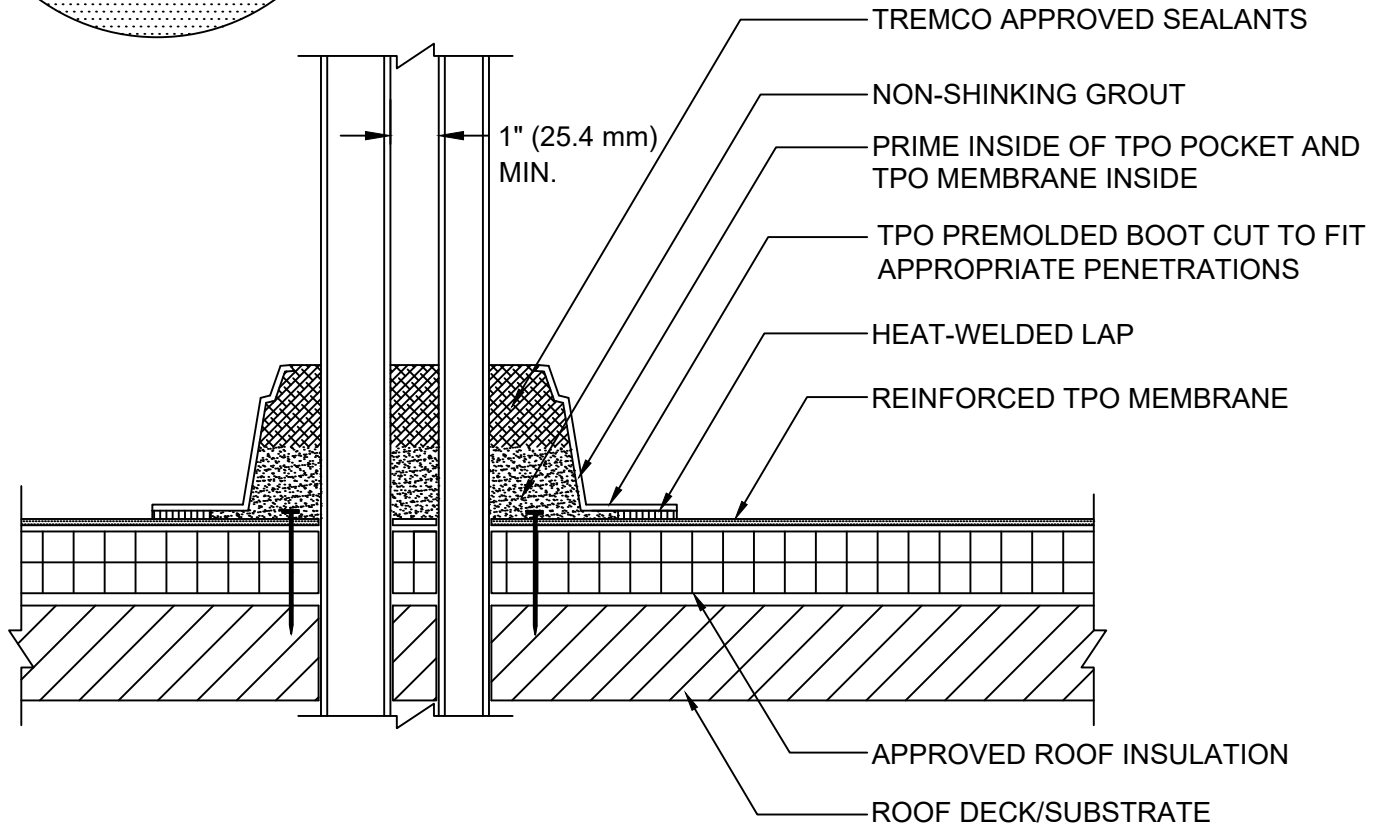

NOTES

1. EXISTING PROJECTION MUST BE CLEANED AND FREE OF INSULATING MATERIALS .
2. DO NOT USE OVER EXISTING PENETRATION POCKETS.
3. DO NOT USE WHEN SERVICE LINE TEMP. EXCEEDS 140°F (60°C).
4. IF THE PLATES AND FASTENERS INTRUDE INTO BOOT FLANGE AREA, THEN A TARGET MUST FIRST BE INSTALLED OVER PLATES AND FASTENERS BEFORE BOOT INSTALLATION.
5. APPLY TPO CUT EDGE SEALANT TO ALL CUT REINFORCED TPO EDGES.



SHEET TITLE:

PREFORMED PENETRATION FLASHING DETAIL

SCALE:

NTS

DRAWING No.:

DWG NO. 63