

FASTENED TO WALL / CURB

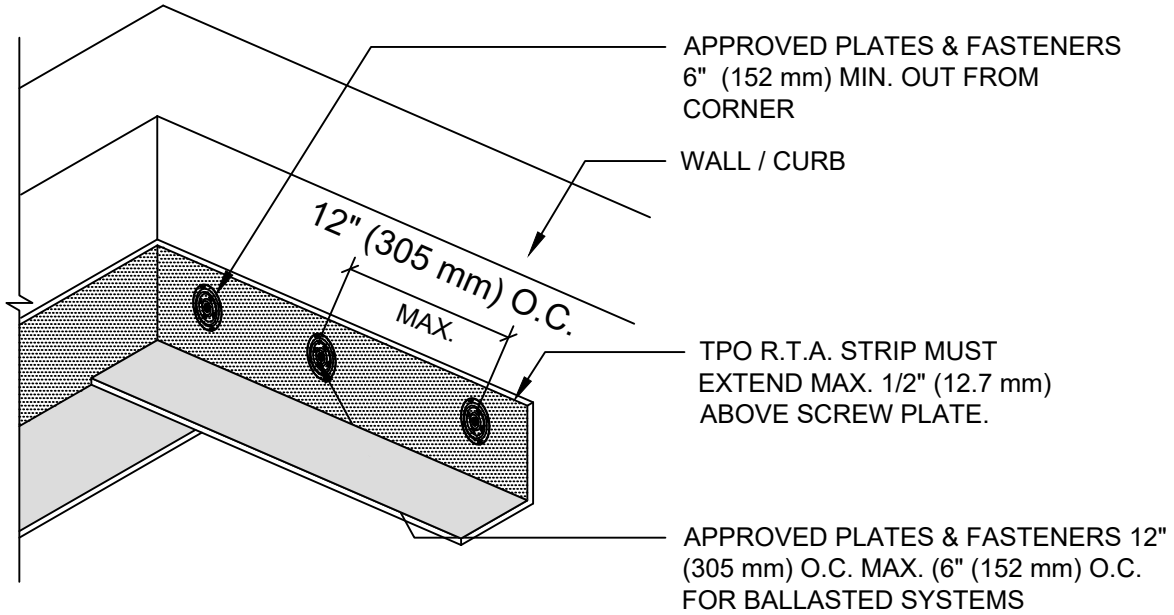

FASTENED TO DECK

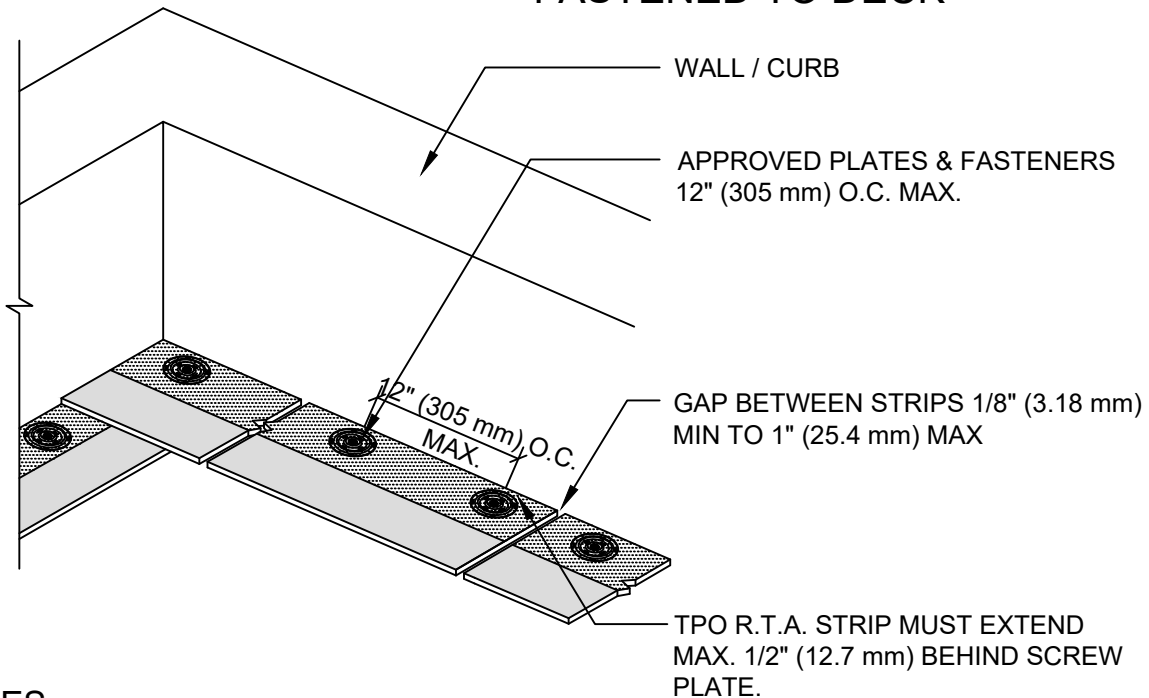

NOTES

1. THIS DETAIL IS NOT TO BE USED FOR TPO MECHANICALLY ATTACHED SYSTEMS.
2. COMMON FASTENER ANCHORING THE OVERLAP OF THE TWO STRIPS IN THE CORNER.
3. FOR INSULATION THICKNESS GREATER THAN 8" (203 mm), A HARD BOARD IS REQUIRED ON MECHANICAL SYSTEMS ONLY.