

FLASHING KEY

- 24" - 54" (610 mm - 1.37 m)
REQUIRES BONDING ADHESIVE
- UP TO 24" (610 mm) DRY HUNG

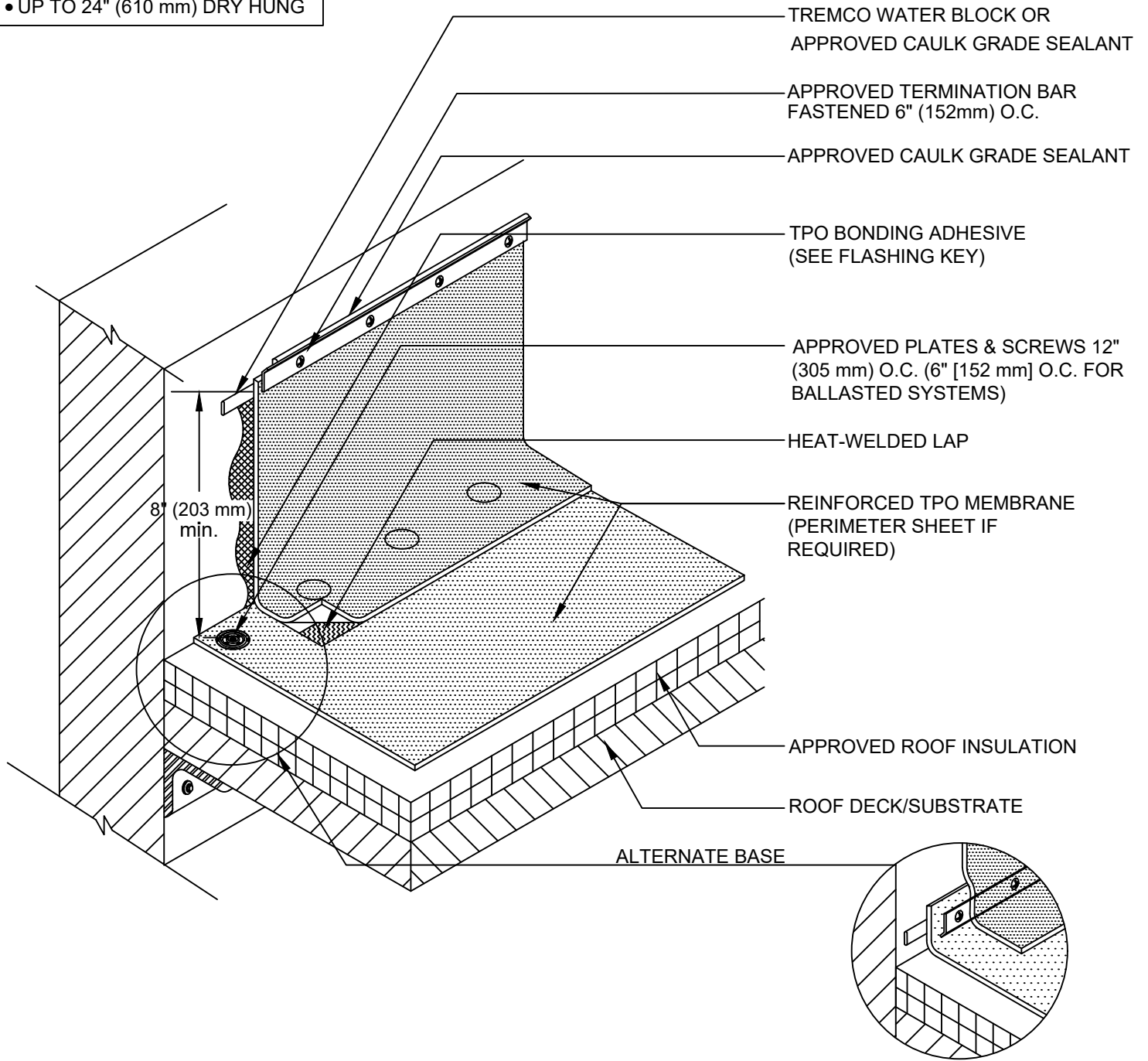

NOTES

1. FOR INSULATION THICKNESS GREATER THAN 8" (203 mm), A HARD BOARD IS REQUIRED ON MECHANICALLY FASTENED SYSTEMS ONLY.
2. APPLY TPO CUT EDGE SEALANT TO ALL CUT REINFORCED TPO EDGES



SHEET TITLE:

WALL/CURB FLASHING WITH
TERMINATION BAR DETAIL

SCALE:

NTS

DRAWING No.:

DWG NO. 101