

TremLock® Trap Tee™

Mechanically Seamed Metal Panel System

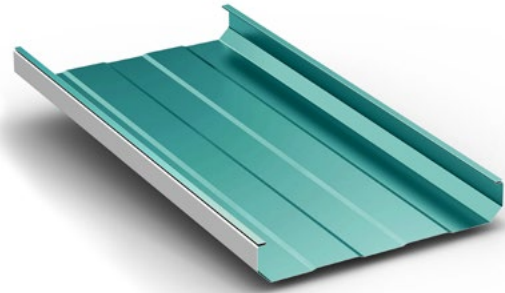

FEATURES

- 2 3/4" tall mechanically seamed Symmetrical Trapezoidal panel
- 1/4:12 minimum roof slope
- Site formed only
- Installs over open framing or solid deck
- Best suited for simple sloped roofs without dormers, hips, valleys or other special conditions
- Single-piece panels up to 250' long
- No lap conditions = Improved weathertightness
- Individual panel replaceability
- Watertight seam design
- Bi-directional seamer
- Seam cap has 2 beads of continuous factory applied sealant

BENEFITS

- No End Laps: Onsite panel production for lengths up to 250', allows most projects to be completed without endlaps. Eliminating end laps saves on labor and increases panel installation production. No end laps means no installation errors that can result in immediate leaks or leaks that occur after the end laps have been stressed.
- Outstanding Wind Uplift: We've specially designed this panel with an oversized seam and special clips which dramatically increase the wind uplift capacity compared to most other panels in the market.
- Easy Repairability: Since standing seam roofs last 60+ years, it's likely any roof will require some sort of modification during its life expectancy. Whether adding curbs, replacing a few panels, or building modifications, building owners and contractors benefit from the panel replaceability our Trap Tee panel offers.

DESCRIPTION

Tremco's 2 3/4" tall symmetrical Trap-Tee system is a site-formed, mechanically seamed system designed to resolve the three major shortcomings of trapezoidal standing seam roof systems: leaking endlaps, low wind uplift capacity, and difficult to repair.

FINISH / COLOR

Acrylic coated Galvalume Fluoropolymer (Kynar 500 PVDF resin-based) Oil canning is inherent in all metal panels and is not cause for panel rejection.

APPLICATION

Mechanically seamed roof panel used on slopes down to 1/4:12.

SUBSTRATES

Plywood, metal deck, rigid insulation/metal deck, or open framing. Best suited for simple sloped metal roofs without dormers, hips, valleys or other special conditions.

PROPERTIES AND PROFILES

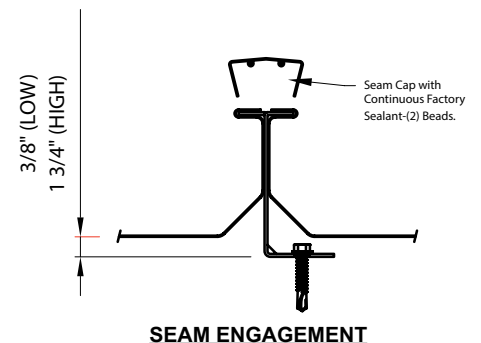
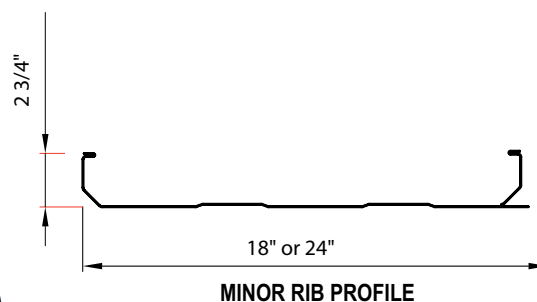

TremLock® Trap Tee™

PROPERTIES AND PROFILES (continued)

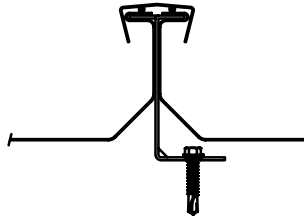

BEFORE SEAMING

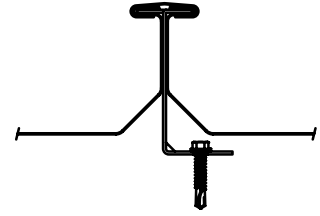

AFTER SEAMING



MECHANICAL SEAMER

Order through Developmental Industries
at www.mcelroyseamers.com
(888)343-0456

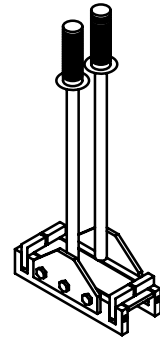

HAND SEAMER

Order through Developmental Industries
at www.mcelroyseamers.com
(888)343-0456



FOAM INSIDE CLOSURE

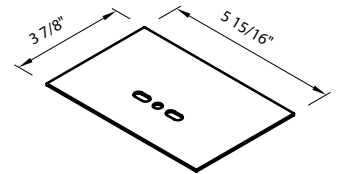

BEARING PLATE

16 GA.
RED PRIMED - ASTM A1011 (55 ksi)
GALVANIZED - ASTM A653 (55 ksi)

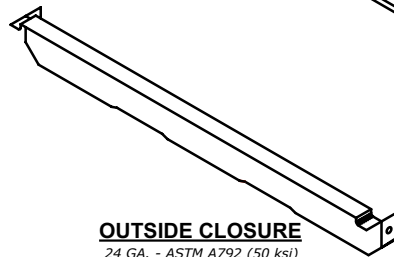

OUTSIDE CLOSURE

24 GA. - ASTM A792 (50 ksi)

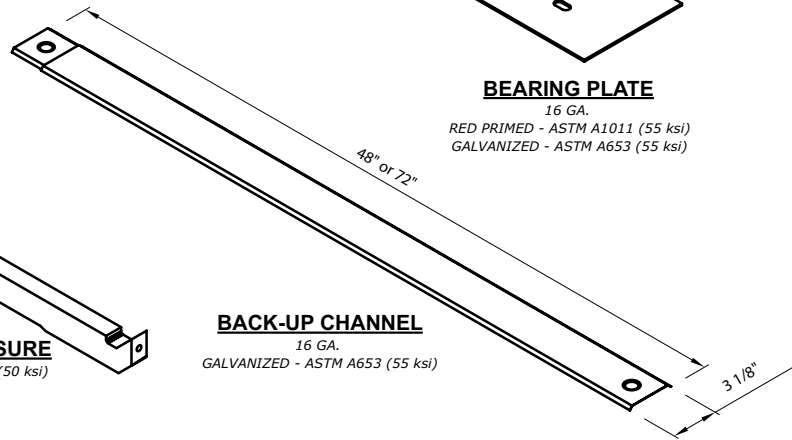

BACK-UP CHANNEL

16 GA.
GALVANIZED - ASTM A653 (55 ksi)

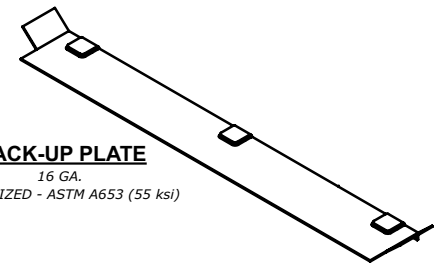

BACK-UP PLATE

16 GA.
GALVANIZED - ASTM A653 (55 ksi)

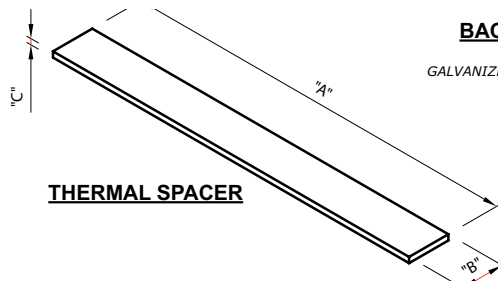

THERMAL SPACER

THERMAL SPACER SIZE CHART

PANEL	"A"	"B"	"C"
24"	22 7/8"	3"	3/8", 5/8", 1" or 1 3/8"

*NOTE: FOR 18" PANELS, FIELD CUT 22 7/8" SPACERS
DOWN TO 16 7/8" LONG.

**PROPERTIES
AND PROFILES**
(continued)

TremLock® Trap Tee™

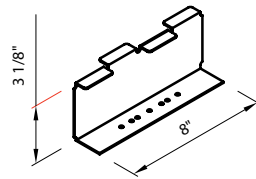

STANDARD CLIP

3/8" Offset
16 GA.

Standard: Galvanized G90 - ASTM A653 (50 ksi)

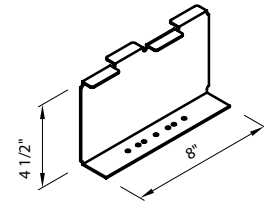

TALL CLIP

1 3/4" Offset
16 GA.

Standard: Galvanized G90 - ASTM A653 (50 ksi)

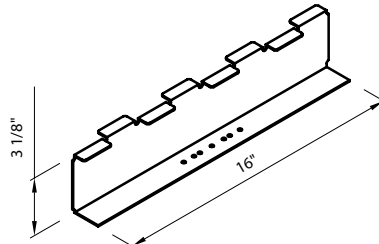

SUPER CLIP

3/8" Offset
16 GA.

Standard: Galvanized G90 - ASTM A653 (50 ksi)

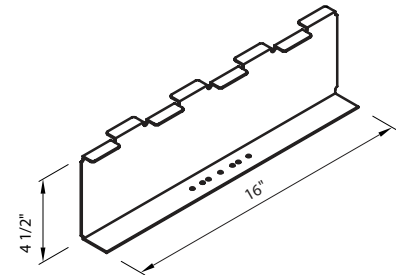

SUPER TALL CLIP

1 3/4" Offset
16 GA.

Standard: Galvanized G90 - ASTM A653 (50 ksi)

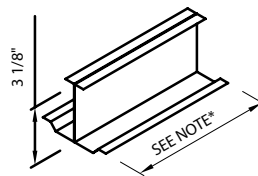

LOW MULTI-SPAN CLIP

3/8" Offset
2-Piece
Standard: 24 GA. - ASTM A792 (50 ksi)
Optional: 22 GA. - ASTM A792 (50 ksi)
*Sold in lengths up to 30'-0"

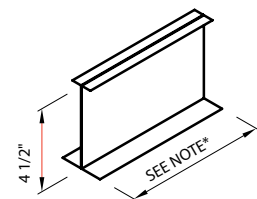

HIGH MULTI-SPAN CLIP

1 3/4" Offset
2-Piece
Standard: 24 GA. - ASTM A792 (50 ksi)
Optional: 22 GA. - ASTM A792 (50 ksi)
*Sold in lengths up to 30'-0"

PHYSICAL PROPERTIES

TESTING*

Uplift: ASTM E1592 (Pending)
Static Waterhead: ASTM 2140 (Pending)
Air & Water Infiltration: ASTM 1680, ASTM 1646 (Pending)
*Testing and Approvals are product specific. Please inquire for details.

MAINTENANCE

Your local Tremco Roofing sales representative can provide you with effective maintenance procedures which may vary, depending upon specific conditions. Periodic inspections, early repairs and preventative maintenance are all part of a sound roof program.

PRECAUTIONS

Users must read container labels and Safety Data Sheets for health and safety precautions prior to use.

TECHNICAL SUPPORT

Your local Tremco Roofing sales representative, working with the Technical Service Staff, can help analyze conditions and needs to develop recommendations for special applications.



3735 Green Road
Beachwood, Ohio 44122
220 Wicksteed Avenue
Toronto, Ontario, M4H 1G7
www.tremcoroofing.com
1.800.852.6013

Tremco Roofing and Building Maintenance is part of Tremco Construction Products Group.

Tremco is a US Registered trademark of Tremco CPG Inc.
The information provided on this data page supersedes all previous data concerning this product and its application.
The Statements provided concerning the materials shown are intended solely as a general guide for material usage and are believed to be true and accurate. Since the manner of use is beyond our control, Tremco DOES NOT MAKE NOR DOES IT AUTHORIZE ANY WARRANTY OF MERCHANTABILITY OR FITNESS FOR ANY PURPOSE, OR ANY OTHER WARRANTY, GUARANTEE OR REPRESENTATION, EXPRESSED OR IMPLIED, CONCERNING THIS MATERIAL EXCEPT THAT IT CONFORMS TO TREMCO'S PRODUCT SAMPLE. Buyer and user accept the product under those conditions and assume the risk of any failure, injury of person or property and loss or liability resulting from the handling, storage or use of the product, whether or not it is handled, stored, used in accordance with directions or specifications. UNDER NO CIRCUMSTANCE SHALL TREMCO BE LIABLE FOR CONSEQUENTIAL OR INCIDENTAL DAMAGES ARISING FROM ANY BREACH OF WARRANTY. IN ALL CASES, TREMCO'S LIABILITY IS LIMITED, AT TREMCO'S OPTION, TO THE REPLACEMENT OF GOODS, OR THEIR VALUE, PROVEN TO BE DEFECTIVE IN MANUFACTURING.